

4620-4624 WISCONSIN AVE NW
SQUARE 1736 + 1732 | LOT 0045 + 0049 • WASHINGTON, D.C.

REVISED

A6
10.12.2017



ZONING COMMISSION
District of Columbia
CASE NO. 16-26
EXHIBIT NO. 55A

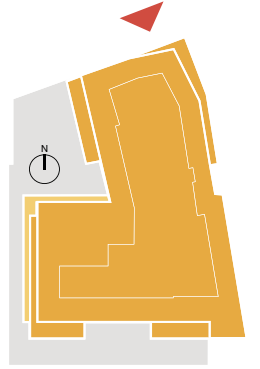

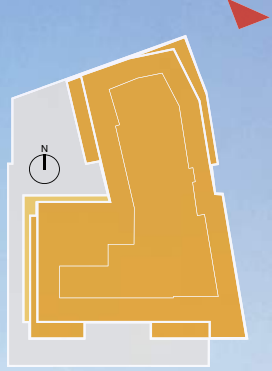

CHANGES TO THE NORTH FACADE:

- ADDED ADDITIONAL AT RISK WINDOW OPENINGS ON LEVEL 6 + 7 TO MAXIMIZE LIGHT AN VIEWS WITHIN THE UNIT.
- ARCHITECTURAL VOCABULARY IN LINE WITH THE MAIN ELEVATION @ WISCONSIN AVENUE, CREATING AN ELEGANT ARTICULATION TO THIS FACADE.



